



Project

Gymnastics Academy -
Manchester, UK



IP65 MultiRay LED p374



Deco LED High Bay



*IP65 MultiRay LED
Low Bay and High Bay*



Opti-Lux LED Linear



*Pre-Wired T8 Non-Corrosive
for LED Tubes*



*Stormloc LED
Non-Corrosive*



*Tornado LED
Non-Corrosive*



382

*Tornado LED 110V
Non-Corrosive*



383

IP65 T8 Non-Corrosive

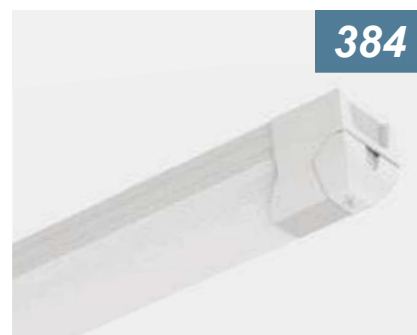

384

Airbeam LED Batten



386

Topline 6 LED Batten



388

T8 Fluorescent Batten



390

*T8 Fluorescent Batten
Accessories*



Designed to
Deliver...

Deco High Bay LED

Supplied c/w Integral Driver



- Decorative modern LED pendant with either polycarbonate refractor or aluminium reflector
- Suitable for industrial, commercial and retail applications
- 41W exceeds performance of 70W HQI
- 96W exceeds performance of 150W HQI
- Matt grey textured powder coated finish
- LED lifespan L70 54,000 hours
- Non-dimmable

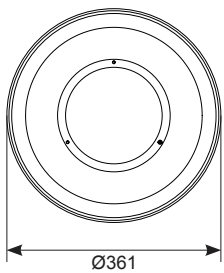
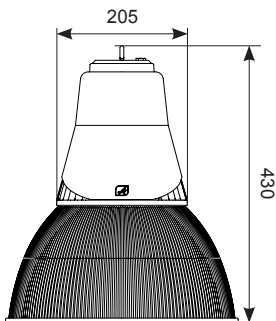

ADHBLED1/PC

Powered by
TRIDONIC
enlightening your ideas



ADHBLED2/ALU

LED Information

Total (Watts)	41W	96W
Lumens Delivered		
/ALU	4678lm	10375lm
/PC	4760lm	10437lm
Lm/W		
/ALU	114lm	109lm
/PC	116lm	109lm
Beam Angle		
/PC		68°
/ALU		63°
CRI		Ra 80
CCT		4000K
Input		230V
Hertz		50/60Hz
Operating Temp		-20°C to 45°C

Code	Lamp	Description
ADHBLED1/PC	LED	41W - c/w PC Refractor
ADHBLED2/PC	LED	96W - c/w PC Refractor
ADHBLED1/ALU	LED	41W - c/w Aluminium Reflector
ADHBLED2/ALU	LED	96W - c/w Aluminium Reflector
Accessories	ADHBLED/PC/BC	PC Bottom Cover (360mm)
	ADHBLED/SK	Suspension Kit



Warrington: +44 (0) 1942 433333
Belfast: +44 (0) 2890 773750



IP65 T8 Pre-Wired Non Corrosive For LED Tubes

Non Corrosive supplied Less Control Gear and Lamp



- Mains Voltage Non Corrosive for Ansell T8 LED Tubes
- Fixture supplied with lockable stainless steel clips as standard

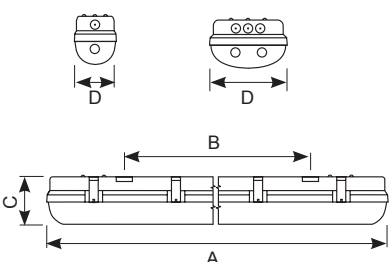

Code	Lamp	Description	A	B	C	D	Clips
ADP2	LED	1 x 600mm for LED Tube	655	478	110	105	4
ADP4	LED	1 x 1200mm for LED Tube	1265	907	110	105	8
ADP5	LED	1 x 1500mm for LED Tube	1565	907	110	105	10
ADP2X2	LED	2 x 600mm for LED Tube	655	478	110	165	4
ADP2X4	LED	2 x 1200mm for LED Tube	1265	907	110	165	8
ADP2X5	LED	2 x 1500mm for LED Tube	1565	907	110	165	10



StormlocTM

ELEMENT PROTECTION **LED**

Unique design of brackets for BESA box mounting or direct ceiling mounting

UV stabilised polycarbonate base for durability and strength

Heavy duty lockable stainless steel clips as standard

TRIDONIC driver (dimnable option available)

Integral microwave sensor option

Dedicated LED circuit for integral Self-Test emergency option

Aluminium gear tray for thermal management to maximise lifetime of LED array

Two fused terminal blocks for surge protection

Optical lens securing end cap

Latest LED chips for maximum performance and efficiency

Visiluxe optical lens maximises performance and light distribution

Provides appearance of traditional fluorescent

Shockproof polycarbonate diffuser for high durability and strength



Stormloc IP65 LED Non-Corrosive

Supplied c/w Integral Driver

- Up to 48% energy saving compared to T8 fluorescent
- Light output exceeds performance of T8 and T5 fluorescent by up to 37%
- LED performance allows point for point replacement of existing fluorescent luminaires
- Internal linear Visiluxe optical lens for maximum performance and light distribution. Provides appearance of traditional fluorescent
- Instant light output with unlimited switching
- Unique luminaire fixing clip design allows option of mounting onto BESA box or directly onto ceiling surfaces
- Lockable heavy duty stainless steel clips supplied as standard for added safety and security
- Polycarbonate base and diffuser maximises durability and strength
- Self-test emergency as standard
- CorridorFUNCTION for dimmable microwave sensor models
- LED lifespan L70 56,000 hours

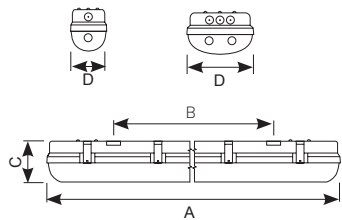

Internal high performance optical lens



Powered by
TRIDONIC
enlightening your ideas

LED Information

Total (Watts)	27W	57W
	37W	73W
	46W	86W
Lumens Delivered	2218lm	4474lm
	3143lm	6103lm
	3652lm	7109lm
Lm/W	82lm	79lm
	84lm	84lm
	79lm	83lm
CRI	Ra 80	
CCT	4000K	
Input	230V	
Hertz	50Hz	
Operating Temp	-20°C to 40°C	

Code	Lamp	Description	A	B	C	D
ASLED4	LED	27W	1265	907	110	105
ASLED5	LED	37W	1565	907	110	105
ASLED6	LED	46W	1858	1170	110	105
ASLED2X4	LED	57W	1265	907	110	165
ASLED2X5	LED	73W	1565	907	110	165
ASLED2X6	LED	86W	1858	1170	110	165

Options	Code	Description
	/M3	Self Test Emergency
	/MWS	Integral Microwave Sensor
	/DD	Digital Dimming (DD1/DD2/DD3/DD4)
	/DD/M3	Digital Dimming Self Test Emergency
	/DD/MWS	Digital Dimming Integral Microwave Sensor
	/DD/MWS/M3	Digital Dimming Integral Microwave Sensor Self Test Emergency



Tornado IP65 LED Non-Corrosive

Supplied c/w Integral Driver



- LED Performance allows point-to-point replacement of existing fluorescent luminaires
- Light output exceeds performance of T8 and T5 fluorescent
- Unique luminaire fixing clip design allows option of mounting onto BESA box
- Lockable heavy-duty stainless steel clips supplied as standard for added safety and security
- Self-test emergency as standard
- LED lifespan L70 35,000 hours
- Non-dimmable

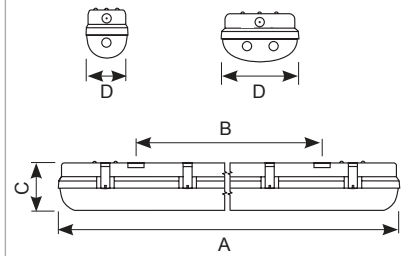

Code	Lamp	Description	A	B	C	D
ATORLED4	LED	20W	1266	860	75	85
ATORLED5	LED	28W	1566	960	75	85
ATORLED6	LED	35W	1866	1030	80	85
ATORLED2X4	LED	40W	1266	860	75	118
ATORLED2X5	LED	58W	1566	960	75	118
ATORLED2X6	LED	71W	1855	1030	80	118

Options	Code	Description
	/M3	Self-Test Emergency
	/MWS	Integral Microwave Sensor
	/MWS/M3	Integral Microwave Sensor Self-Test Emergency

LED Information

Total (Watts)	20W	40W
	28W	58W
	35W	71W
Lumens Delivered	2088lm	4425lm
	3230lm	6353lm
	3823lm	7320lm
Lm/W	104lm	110lm
	115lm	110lm
	109lm	103lm
CRI	Ra 80	
CCT	4000K	
Input	230V	
Hertz	50Hz	
Operating Temp	-10°C to 40°C	





Project - Source Park
Hastings, UK

Tornado 110V LED

Supplied c/w Integral Driver



- LED Performance allows point-to-point replacement of existing fluorescent luminaires
- Suitable for all types of site lighting
- Light output exceeds performance of T8 and T5 fluorescent
- Unique luminaire fixing clip design allows option of mounting onto BESA box
- IK08 Rating
- Lockable heavy-duty stainless steel clips supplied as standard for added safety and security
- Self-test emergency as standard
- LED lifespan L70 35,000 hours
- Non-dimmable

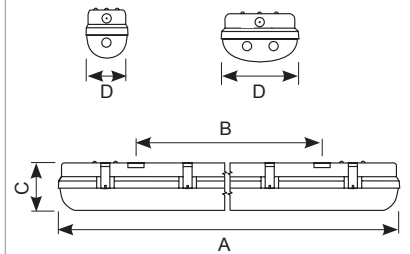

Code	Lamp	Description	A	B	C	D
ATORLED4/110V	LED	20W	1266	860	75	85
ATORLED5/110V	LED	28W	1566	960	75	85
ATORLED2X4/110V	LED	40W	1266	860	75	118
ATORLED2X5/110V	LED	58W	1566	960	75	118

Options	/M3	Self-Test Emergency
----------------	-----	---------------------

LED Information

Total (Watts)	20W	28W
	40W	58W
Lumens Delivered	2088lm	3230lm
	4225lm	6353lm
Lm/W	104lm	115lm
	110lm	110lm
CRI	Ra 80	
CCT	4000K	
Input	100/240V	
Hertz	50Hz	
Operating Temp	-10°C to 40°C	

Airbeam LED Batten

Supplied c/w Integral Driver

384



Powered by
TRIDONIC
enlightening your ideas

- High performance LED batten for multi-purpose applications
- Up to 56% energy saving compared to T8 fluorescent
- Steel body construction with powder coat finish
- Polycarbonate reeded diffuser and end caps
- Instant light output with unlimited switching
- Self-test emergency as standard
- CorridorFUNCTION for dimmable microwave sensor models
- LED lifespan L70 56,000 hours

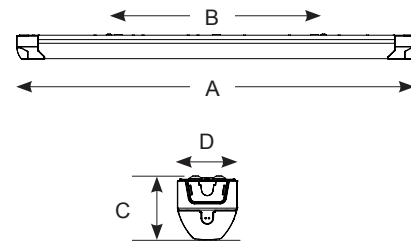

	Code	Lamp	Description	A	B	C	D
Standard	ABLED4	LED	1 x 24W	1220	600	77	76
	ABLED5	LED	1 x 33W	1525	600	77	76
	ABLED6	LED	1 x 42W	1820	600	77	76
	ABLED2X4	LED	1 x 52W	1220	600	77	76
	ABLED2X5	LED	1 x 61W	1525	600	77	76
	ABLED2X6	LED	1 x 84W	1820	600	77	76

Options	/M3	Self-Test Emergency
	/MWS	Integral Microwave Sensor
	/MWS/M3	Integral Microwave Sensor Self-Test Emergency
	/DD	Digital Dimming (DD1/DD2/DD3/DD4 - ABLED2X6 Not Available)
	/DD/M3	Digital Dimming Self-Test Emergency
	/DD/MWS	Digital Dimming Microwave Sensor
	DD/MWS/M3	Digital Dimming Microwave Sensor Self-Test Emergency

LED Information

Total (Watts)	24W	52W
	33W	61W
	42W	84W
Lumens Delivered	2778lm	5517lm
	3608lm	6407lm
	4189lm	7910lm
Lm/W	116lm	106lm
	109lm	105lm
	100lm	94lm
CRI	Ra 80	
CCT	4000K	
Input	230V	
Hertz	50Hz	
Operating Temp	0°C to 25°C	

CE \oplus DD M3 MWS IP20

- *Push and release end cap for quick access*

- *Connection option via 20mm conduit entry*

- *Optional fixing through end cap if required*
- *BESA box fixing as standard*



Push Release End Cap



20mm Conduit Entry Facility

- *Unique ceiling mounting 'shunt' facility provides installer with flexibility and ease of adjustment when continuous mounting*



End Cap Fixing Option



**Ceiling Mounting
Continuous Fixings**

Topline 6 LED Batten

Supplied c/w Integral Driver



Powered by
TRIDONIC
enlightening your ideas



- High performance LED batten for multi-purpose applications
- Exceeds performance of T5 equivalents
- Steel body construction with powder coat finish
- Unique opal diffuser design for optimum performance and light distribution
- Polycarbonate end caps
- Instant light output with unlimited switching
- Self-test emergency as standard
- LED lifespan L70 36,000 hours
- Non-dimmable

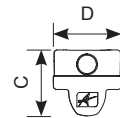
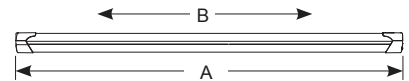

Code	Lamp	Description	A	B	C	D
ATLLED4	LED	29W - Cool White	1220	600	65	65
ATLLED5	LED	35W - Cool White	1525	600	65	65
ATLLED6	LED	41W - Cool White	1745	600	65	65
ATLLED2X4	LED	49W - Cool White	1220	600	65	65
ATLLED2X5	LED	66W - Cool White	1525	600	65	65
ATLLED2X6	LED	83W - Cool White	1745	600	65	65

Options	/M3	Self-Test Emergency
----------------	-----	---------------------

LED Information

Total (Watts)	29W	49W
	35W	66W
	41W	83W
Lumens Delivered	2874lm	5085lm
	3745lm	6514lm
	4372lm	9003lm
Lm/W	99lm	104lm
	107lm	99lm
	107lm	108lm
	107lm	108lm
CRI	Ra 80	
CCT	4000K	
Input	220/240V	
Hertz	50Hz	
Operating Temp	-10°C to 50°C	



TOP LINE 6™

LED Batten

